

SCW-75B4

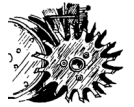

SPADING CLOSING WHEEL

Installation Instructions



Martin Planter Attachments

Martin Industries LLC

206 Elk Fork Road

Elkton, KY 42220

Telephone: 270-265-5817

E-Mail: martin@martinandcompany.com

www.martinandcompany.com



WHEELS ON THE RIGHT OF DRILL (VIEWED FROM BEHIND)
 ROTATE COUNTER-CLOCKWISE, WITH THE TAPERED
 TEETH EXITING THE SOIL AS ILLUSTRATED ABOVE.

NOTE:
SCW-75B4R SHOWN ABOVE.
SCW-75B4L IS OPPOSITE.

INSTRUCTIONS FOR SCW 74B ASSEMBLY.

- 1) Place the BC01 bearing cover onto the A3458R axle as illustrated right.
- 2) Push the A3458R axle up through the hole in the bearing within the HU44B2 hub.
- 3) Add the 5/8 nyloc nut and torque to 90 ft lb.
- 4) Add the TW3813L wheel (with the TW3813L letters towards the seed row) to the HU44B2 hub assembly, align the holes in the TW3813L wheel with the holes in the HU44B2 hub.
- 5) Insert the four 3/8 carriage bolts through the holes, thread on the four 3/8" flanged nuts and torque to 35 ft lb.
- 6) Add the HS1328 dust cap.
- 7) The Instructions (and illustration) above are for the right side, left side will be same but will use the TW3813R wheel and A3458L axle.

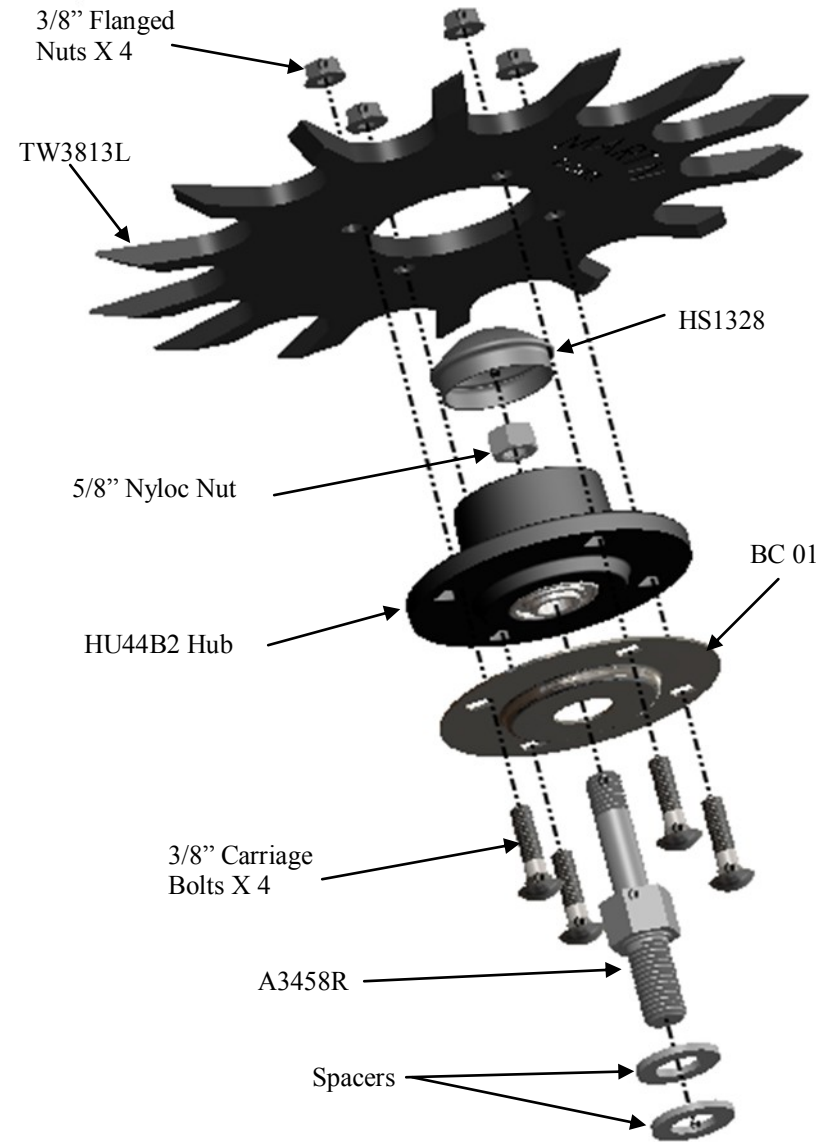

**INSTALLING THE 13" SPIKED CLOSING WHEEL ON THE
 RIGHT SIDE OF THE DRILL (WHEN VIEWED FROM BEHIND)**

- 1) Remove existing smooth closing wheel from drill by unthreading axle from closing wheel arm.
- 2) Install the SCW-75B4R on the right side and SCW75B4L on the left side.
- 3) Add or remove spacers as needed. We have found that 2 spacers are required for most soil conditions.