

# BDD I360

## I360 FRAME WITH DD MOUNT

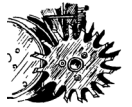

### Installation Instructions



#### **Martin Planter Attachments**

**Martin Industries LLC**

206 Elk Fork Road

Elkton, KY 42220

Telephone: 270-265-5817

E-Mail: [martin@martintill.com](mailto:martin@martintill.com)

[www.martintill.com](http://www.martintill.com)

**INSTALLING THE WHEEL ASSEMBLY WITH D-LOCK TO THE 1360 FRAME**

- 1) Place the TW3813L4 wheel on to hub, insert the four 3/8 x 1 3/4 carriage bolts thru the four square holes in the hub and the TW3813L4 wheel then place the STW04 wheel on to the hub and carriage bolts add the four 3/8 nuts to the carriage bolts.
- 2) Align the D-lock (DLR-01) with the hole in the 1360 Frame and place it up against the 1360 Frame.
- 3) Attach the wheel assembly to the 1360 Frame aligning the flat on Axle with the flat on D-Lock, Insert the 5/8 x 1 1/2 Patch Bolt and Star Washer and tighten.
- 4) Repeat the process for the opposite side.

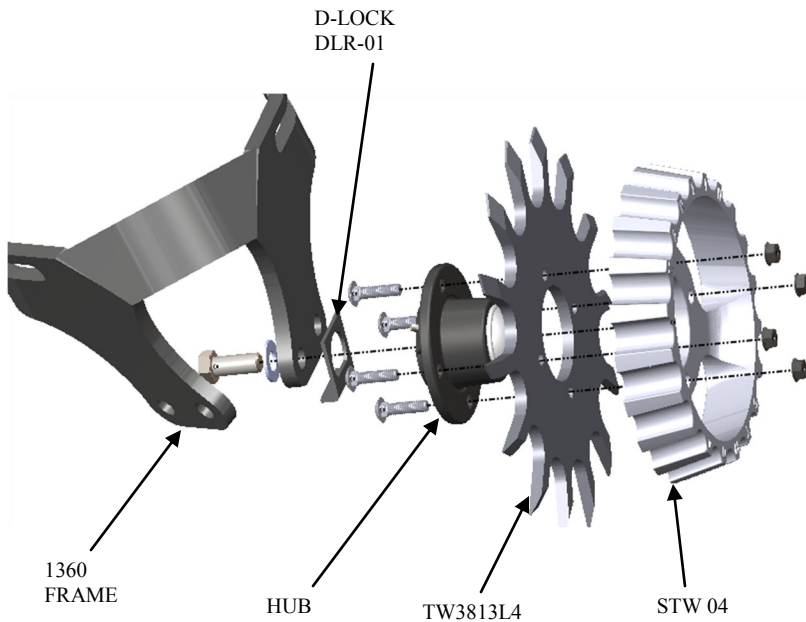

**Hardware Required**

- |                               |       |
|-------------------------------|-------|
| 1) 3/8 x 1 3/4 Carriage Bolts | Qty 4 |
| 2) 3/8 Nuts                   | Qty 4 |
| 3) 5/8 x 1 1/2 Patch Bolt     | Qty 1 |
| 4) 5/8 Star Washer            | Qty 1 |

**INSTALLING THE OPTIONAL CAM ASSEMBLY**

- 1) Mount Cam Block to FR1360 using the four 3/8" Button Head bolts and tighten
- 2) Slide the 1/2" X 4" bolt thru the knob. And add spring to bolt
- 3) Slide the Bolt, spring and handle thru the FR1360 and cam block.
- 4) Add Cam onto bolt and pins in Cam Block.
- 5) Add 1/2" nut.

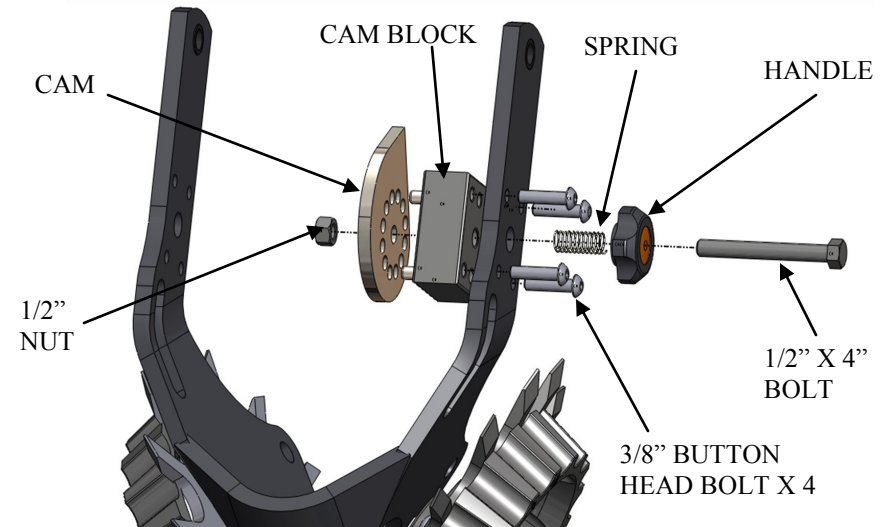

**Install cam block with notched corner positioned as shown below.**



**ATTACHING THE 1360 FRAME ASSEMBLY TO THE 1360DD MOUNT ASSEMBLY**

- 1) Place the Spacer Block and Cam Arm up to the frame push the 5/8 x 3 bolt thru the hole add the 5/8 nut.
- 2) Align the holes in the frame and mount, insert the 7/8 bushings.
- 3) Place the 5/8 washers on the 5/8 bolts.
- 4) Push the 5/8 x 2 bolt thru the hole, push the 5/8 x 3 1/2 bolt thru the opposite side and add the 5/8 nuts.
- 5) Tighten all nuts.

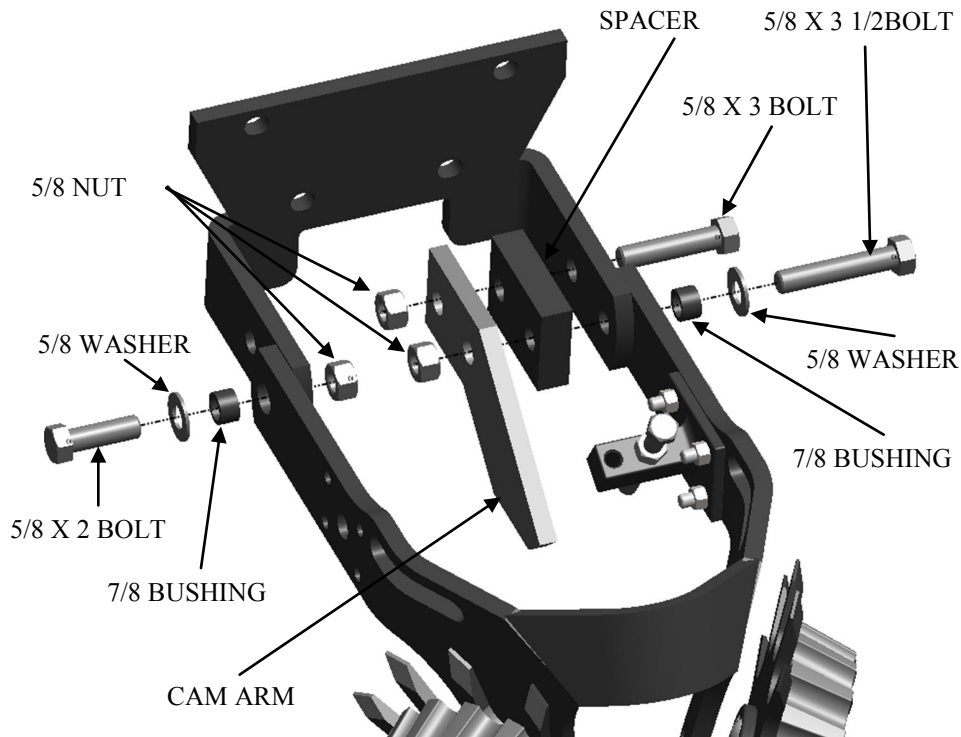

**INSTALLING THE WHEEL ASSEMBLY WITH D-LOCK DEFLECTOR (DLD-02) TO THE 1360 FRAME (OPTIONAL SUPPLIED WITH FR 1360 KIT FOR EXTREME TRASHY CONDITIONS)**

- 1) Place the TW3813L4 wheel on to hub, insert the four 3/8 x 1 3/4 carriage bolts thru the four square holes in the hub and the TW3813L4 wheel then place the STW04 wheel on to the hub and carriage bolts add the four 3/8 nuts to the carriage bolts.
- 2) Align the D-lock Deflector (DLD-02) with the hole in the 1360 Frame and place it up against the 1360 Frame.
- 3) Attach the wheel assembly to the 1360 Frame aligning the flat on Axle with the flat on D-Lock Deflector, Insert the 5/8 x 1 1/2 Patch Bolt and Star Washer and tighten.
- 4) Repeat the process for the opposite side.

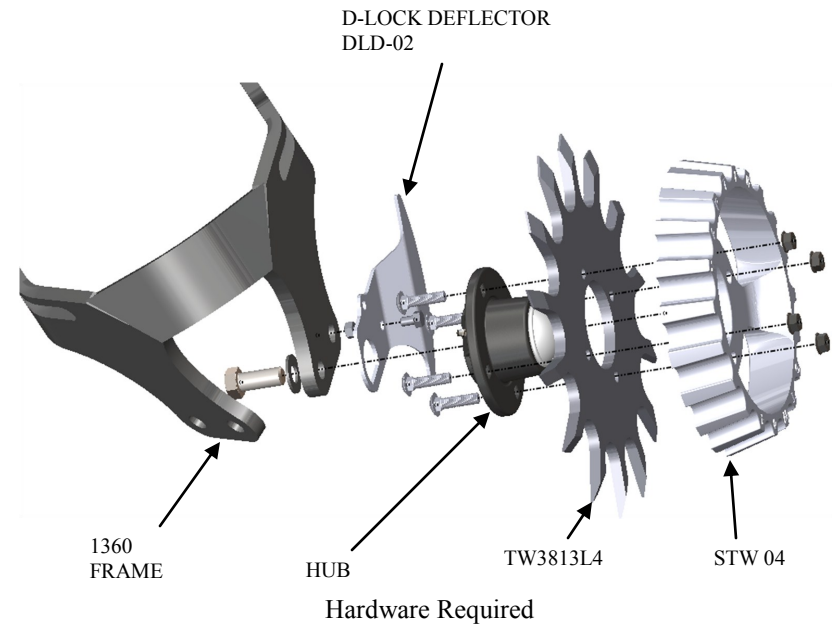

- |                               |       |
|-------------------------------|-------|
| 1) 3/8 x 1 3/4 Carriage Bolts | Qty 4 |
| 2) 3/8 Nuts                   | Qty 4 |
| 3) 5/8 x 1 1/2 Patch Bolt     | Qty 1 |
| 4) 5/8 Star Washer            | Qty 1 |
| 5) 5/16 x 1/2 Bolt            | Qty 1 |
| 6) 5/16 Nut                   | Qty 1 |

**ATTACHING THE WHEEL WITH D-LOCK DEFLECTOR TO THE FR1360 FRAME FOR DIFFERENT SOIL CONDITIONS**

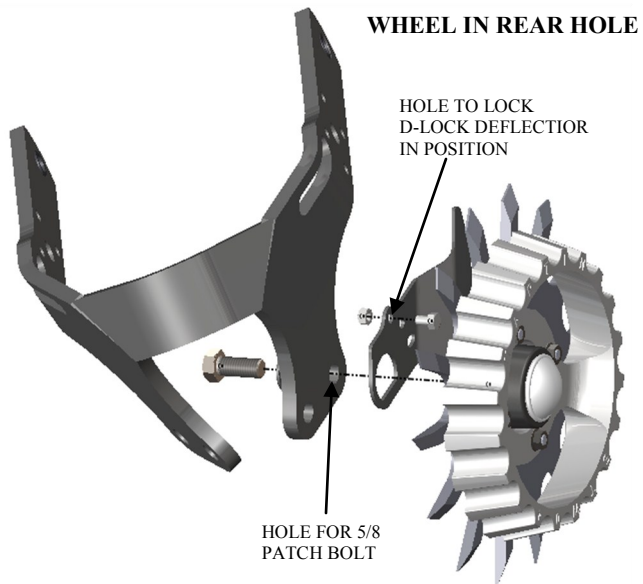
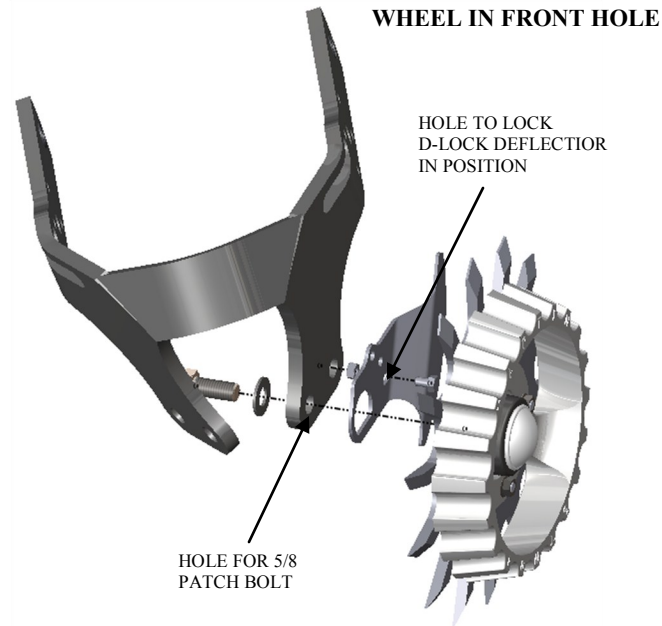

**Install Threaded Adjustment Assembly**

1. Place the Adjustment Assembly as shown in diagram below.
2. Insert the four 3/8 x 1 1/2 bolts and add the 3/8 nuts
3. Put the 1/2 nut on the 1/2 x 4 bolt.
4. Thread the 1/2 x 4 bolt in the tapped hole in the Adjustment As-



**Hardware Required**

- |                      |       |
|----------------------|-------|
| 1) 3/8 x 1 1/2 Bolts | Qty 4 |
| 2) 3/8 Nuts          | Qty 4 |
| 3) 1/2 x 4 Bolt      | Qty 1 |
| 4) 1/2 Nut           | Qty 1 |